



**BENJAMIN MARCUS HOMES**

*High Quality Custom Homes*

THE *Hamlet* OF SPRINGDALE



# THE *Hamlet* OF SPRINGDALE

## HOME AND LOT PACKAGES STARTING AT: \$849,000

+ A flagship development for BMH, the Hamlet of Springdale is entering Phase VI and now taking lot deposits.

+ An enchanting European-style retreat, the Hamlet of Springdale is a beautiful neighborhood setting, offering lots from 0.5 to 0.9 acres.

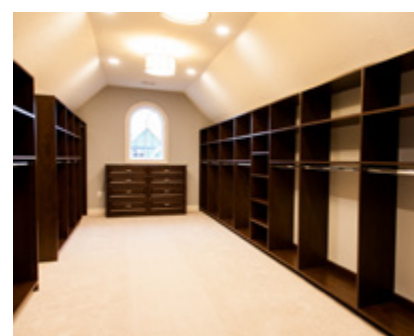



# ESTATE SERIES

## PACKAGE INCLUDES:

---

- Stainless Steel Appliances
- 42" Maple Cabinetry
- Upgraded Countertops
- Hardwood Floors
- Ceramic Tile Tub & Shower Surrounds
- 8' Solid Core Doors on Main Floor
- 10' Ceilings on First Floor
- Designer Light Fixtures
- 10' Ceiling Height in Basement
- Brick & Stone Masonry Facade
- Heated Garages
- Landscape Package



# HAMLET OF SPRINGDALE SITE PLAN

+ These lots feature 50 ft. building setbacks and a minimum width of 110 ft. at the building line allowing all lots to accommodate both an attached garage and a first floor master (if desired).

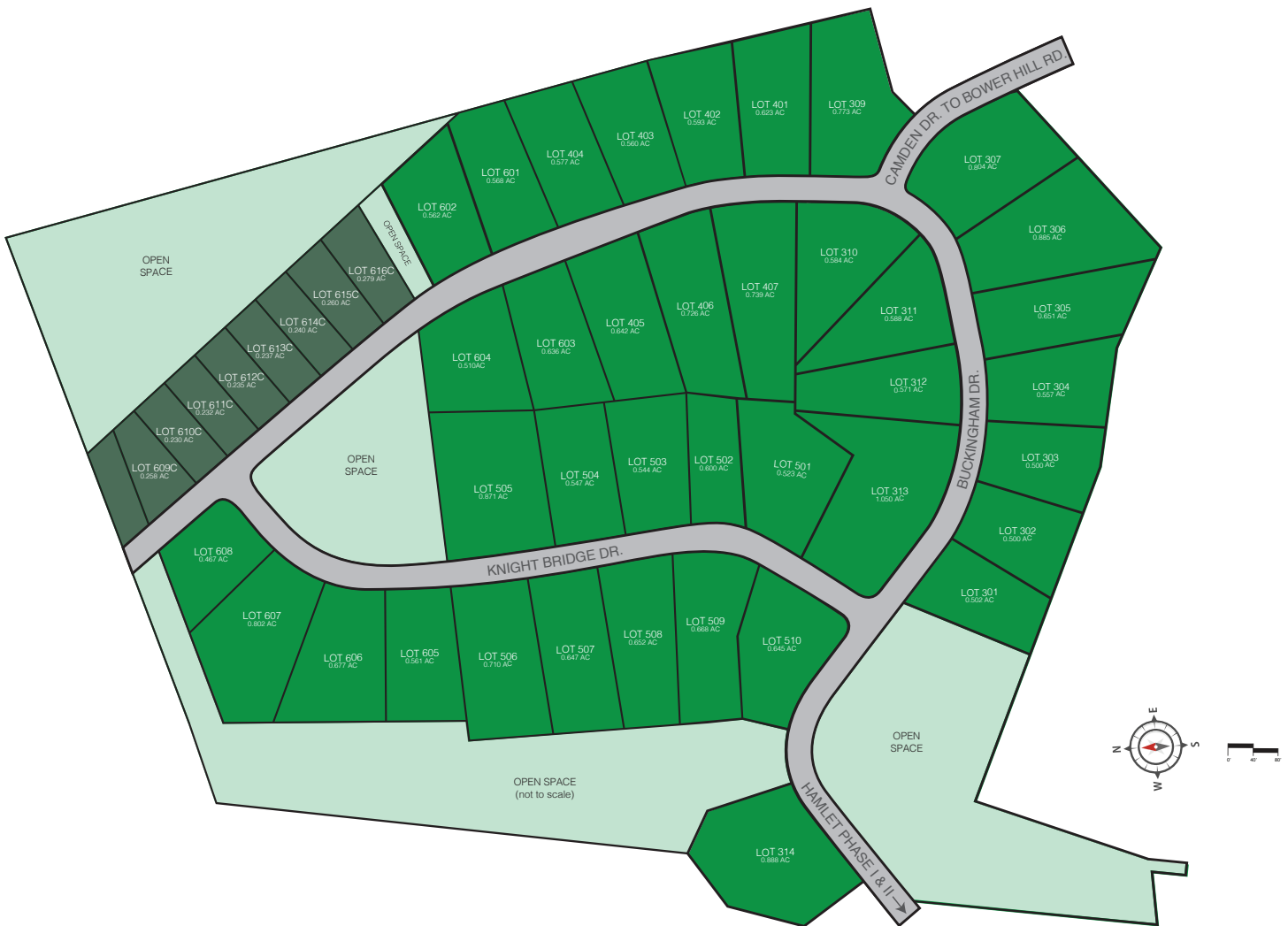

## BENJAMIN MARCUS HOMES HEADQUARTERS & DESIGN GALLERY

121 Hillpointe Drive, Suite 700, Canonsburg, PA 15317

724.255.0861 | [www.benjaminmarcushomes.com](http://www.benjaminmarcushomes.com) | [info@benjaminmarcushomes.com](mailto:info@benjaminmarcushomes.com)

Copyright © 2018 Benjamin Marcus Homes

